

Measuring for your new blinds is easier than you might think! All you have to do is follow our simple tips, double-check everything you do, and set aside some time to do it. Happy measuring!

This guide works for:

- Wooden blinds
- Faux Wooden blinds
- 25mm Venetian blinds
- 50mm Venetian blinds
- Synergy Venetian blinds

Standard Windows

Recess Fitting



Exact Fitting



These handy video guides will walk you through measuring for **recess fitting** (fitting the blind inside the window recess) and **exact fitting** (fitting the blind onto the wall above the recess).

For a step-by-step written guide and for advice if your windows are a little more unusual (e.g. bay windows, or recesses that are partly tiled), keep scrolling down.

Recess fitting

Measure the full width and height of the recess [the size of the hole if you like] and we will make the appropriate deductions to ensure a perfect fit.

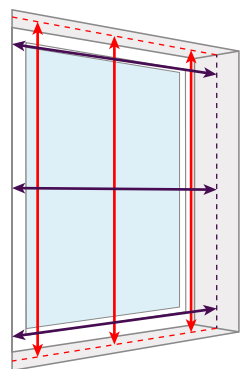

- **Measure in 3 places** for both the width and the drop, **use the smallest measurement**
- **Don't make any deductions**, we'll deduct 10mm from the width to ensure your blind fits perfectly
- **Use a metal tape measure**, cloth ones can stretch and give you inaccurate measurements

Top-Tip:

Check that your recess is deep enough to fit the blind into, also bearing in mind any obstructions such as handles (see table).

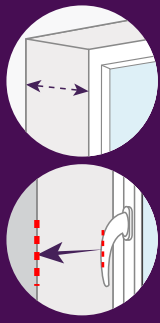

Wooden & Faux Wooden

Slat Size	Depth
25mm	55mm
35-38mm	65mm
50mm	70mm
63-65mm	80mm

Aluminium Venetian

Slat Size	Depth
25mm	30mm
50mm	65mm
Synergy	70mm

Exact fitting

Measure the full width and height of the recess [the size of the hole if you like] and add a little extra to the top and to each side, we will make the blind to the size you specify with no deductions.

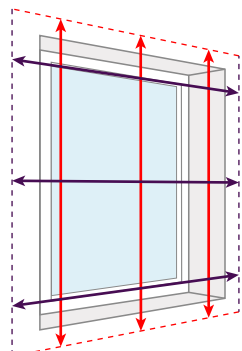

- To minimize light leakage **we recommend that the blind overlaps the window recess by at least 70mm at the top and 50mm each side**
- The overlap at the bottom of the blind is a matter of personal choice but please **take into account obstacles** such as radiators

Top-Tip:

If you are **replacing an existing blind** with one of the same size, simply measure the blind (including its fittings) and specify exact fitting, we will make you one the same size.

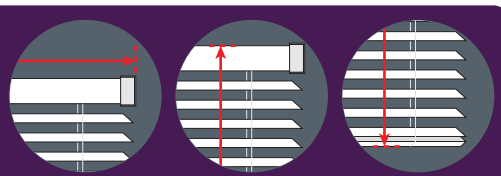

Other Windows

Part-tiled recesses

If you have tiles part-way up your recess (often the case in kitchens and bathrooms) then the space between them is most likely to be the narrowest point in the recess.

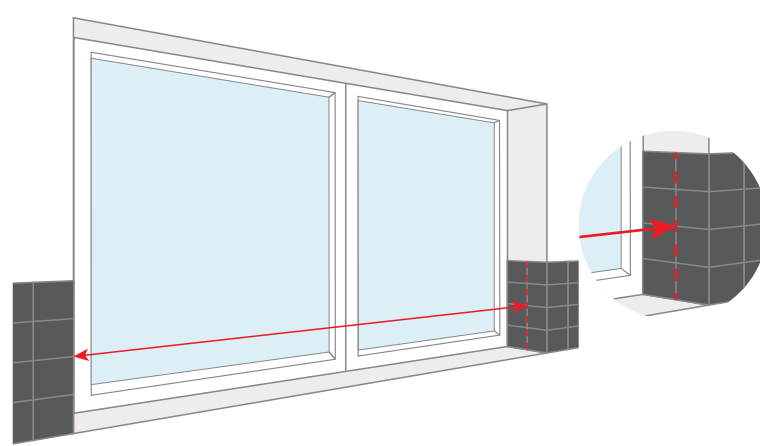

Measure between the tiles to ensure your blind will fit. You will need to top-fix or face-fix your brackets in this case.

Top-Tip:

Do the same if you have a picture rail, skirting board or other items on the inside of the recess.

Bay windows, half-bays & L-shaped windows

We have some handy guides already put together especially for wooden blinds in bay windows, click on the links below to take a look!

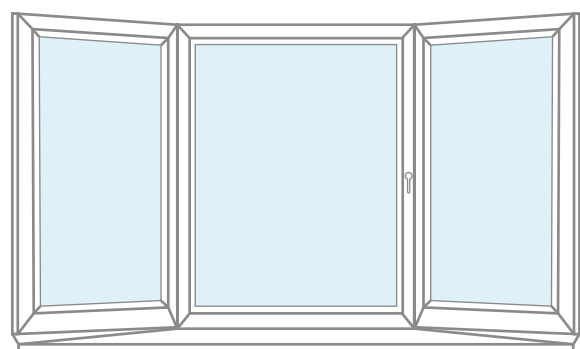

Angled bay windows

You can use these same guides for angled half-bay windows, it's the same principle

[Click here](#) for wooden & faux wood blinds

[Click here](#) for 25mm Venetian blinds

[Click here](#) for 50mm & Synergy Venetian blinds

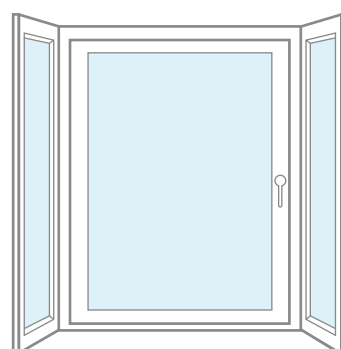

Square bay windows

You can use these same guides for L-shaped windows, it's the same principle

[Click here](#) for wooden & faux wood blinds

[Click here](#) for 25mm Venetian blinds

[Click here](#) for 50mm & Synergy Venetian blinds

Unique Features

Some of our wooden and Venetian blinds come with a decorative pelmet, or valance, which covers the headrail. The blinds that come with pelmets are:

- Real wooden blinds
- Faux wooden blinds
- Synergy Venetian blinds

The pelmet is cut to the size and shape that is most suitable for the fitting type you've chosen:

Pelmets for Recess Fitting

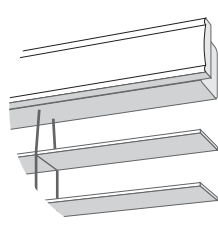

When you choose recess fitting we will make the pelmet for your blind slightly wider than the blind itself so that the pelmet is a tight fit at the top of the recess and to prevent gaps.

Pelmets for Exact Fitting

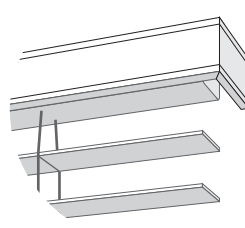

When you choose exact fitting we will make your pelmet a few centimetres wider than the blind and include side returns, so that the brackets are not visible either side.

Top-Tip:

If you find that the pelmet is slightly too wide to fit into your recess then it can be easily trimmed using a fine-tooth saw.